

7th INTERNATIONAL FORUM ON MOOD AND ANXIETY DISORDERS

BUDAPEST, 05-07 DECEMBER, 2007



WEB SITE: www.aim-internationalgroup.com/2007/ifmad



F i n a l P r o g r a m m e

IMPORTANT ADDRESSES

Scientific and Organizing Secretariat

PUBLI CREATIONS - Partner of AIM

74, Bd d'Italie - 98000 Monte-Carlo - Monaco

Ph. +377 97973555 - Fax +377 97973550

E-mail: ifmad@publiccreations.com

Web site: www.aim-internationalgroup.com/2007/ifmad

Housing AIMS International Congress Services

Honvéd u. 22.III.2 - H - 1054 Budapest

Ph. +36 1 2662943 - Fax +36 1 2662946

E-mail: ifmad07@aims-international.com

Web site: www.aims-international.com

Congress Venue

Hilton Budapest, Hess András tér 1-3, 1014 Budapest, Hungary

Ph. +36 1 8896600 - Fax +36 1 8896644

Web site: www.hilton.com





SCIENTIFIC AND LOCAL COMMITTEES	4
WELCOME LETTER	5
FORUM VENUE	6
PROGRAMME OVERVIEW	7
AKNOWLEDGEMENT	8
SCIENTIFIC PROGRAMME	9
POSTERS	13
SCIENTIFIC INFORMATION	19
GENERAL INFORMATION	20
<i>ANNOUNCEMENT NEXT FORUM</i>	22





SCIENTIFIC COMMITTEE

Chairman

Siegfried Kasper (*Austria*)

Co-Chairman

Stuart A. Montgomery (*United Kingdom*)

Scientific Advisers

Christer Allgulander (*Sweden*), A. Carlo Altamura (*Italy*),
David Baldwin (*United Kingdom*), Graham Burrows (*Australia*),
Giovanni B. Cassano (*Italy*), Koen Demyttenaere (*Belgium*)
J.A. den Boer (*The Netherlands*), T. Dinan (*Ireland*), Elias Eriksson (*Sweden*),
Naomi Fineberg (*United Kingdom*), Teruhiko Higuchi (*Japan*),
Robert M.A. Hirschfeld (*USA*), Sidney H. Kennedy (*Canada*),
Jean-Pierre Lépine (*France*), Mario Maj (*Italy*),
Alexander A. Mathé (*Sweden*), Julien Mendlewicz (*Belgium*),
Hans-Jürgen Möller (*Germany*), George Papadimitriou (*Greece*),
Philippe Robert (*France*), Alan F. Schatzberg (*USA*),
Dan J. Stein (*South Africa*), Trisha Suppes (*USA*), Eduard Vieta (*Spain*),
Lars von Knorring (*Sweden*), D. Winkler (*Austria*),
Shigeto Yamawaki (*Japan*), Joseph Zohar (*Israel*).

LOCAL COMMITTEE

Istvan Bitter (*Hungary*), Zoltan Janka (*Hungary*), Zoltan Rihmer (*Hungary*)



The International Forum on Mood and Anxiety Disorders (IFMAD) meeting is held from 5th to 7th December, 2007 in Budapest, Hungary.

IFMAD has become an important forum for the exchange of ideas on the latest developments in psychiatric treatments where international experts can address in an informal atmosphere some of the important topics in the field of mood and anxiety disorders. The meetings are particularly valued for the high quality of the scientific contributions and the opportunity for focused discussion of new data presented in a constructive and productive environment.

Attendees at previous meetings have appreciated the very efficient and agreeable formula provided by IFMAD meetings for keeping up to date with current treatment issues. We look forward to renewing old acquaintances and to welcoming an even wider and international audience.

It is our pleasure to welcome you in Budapest, Hungary in 2007.

Siegfried Kasper
Chairman

Stuart A. Montgomery
Co-Chairman



FORUM VENUE

Ballroom Level

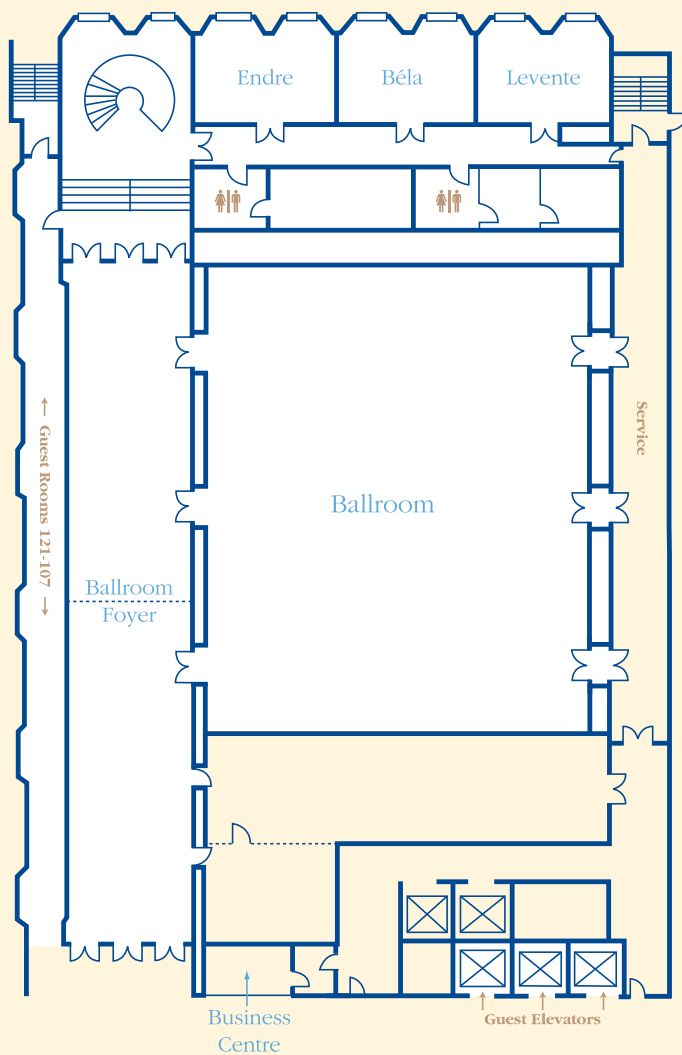

Ballroom: Scientific Sessions

Ballroom Foyer: Exhibition, Secretariat, Coffee Breaks

Endre & Béla rooms: Posters

Levente room: Slide Preview

PROGRAMME OVERVIEW



**Wednesday,
December 5**



13.45/15.45
Suicide

15.45/16.00
Coffee break

16.00/18.00
Improving Signal Detection
in Placebo-Controlled
Studies

18.00/19.00
Opening reception

**Thursday,
December 6**



08.30/10.30
Treatment Resistant
Depression

10.30/10.45
Coffee break

10.45/12.45
Treatment of depression and
anxiety in the "Post SSRI era"

12.45/13.45
Lunch

13.45/15.45
The importance of sleep
in depression

15.45/16.00
Coffee break

16.00/18.00
Everyday Problems in treating
depression - Focus on SNRIs

18.00/20.00
OCD:
defining new boundaries

**Friday,
December 7**

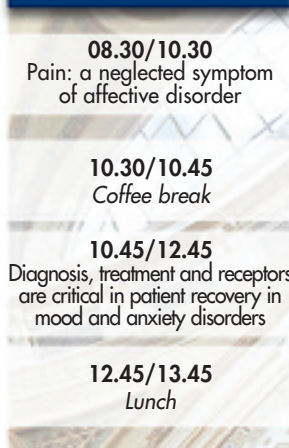

08.30/10.30
Pain: a neglected symptom
of affective disorder

10.30/10.45
Coffee break

10.45/12.45
Diagnosis, treatment and receptors
are critical in patient recovery in
mood and anxiety disorders

12.45/13.45
Lunch

13.45/15.45
Treatment of the elderly

15.45/16.00
End of meeting





ACKNOWLEDGEMENT

The Organising Committee express their gratitude
to the following Companies:

ASTRAZENECA
H. LUNDBECK A/S
PIERRE FABRE MEDICAMENT

for their contribution as Sponsors of Symposia

LILLY BOEHRINGER INGELHEIM

for their support with an educational grant

PIERRE FABRE MEDICAMENT
WISEPRESS LTD

as Sponsor to the programme and participation in the exhibition



WEDNESDAY, December 5, 2007

13.45 - 15.45

SO 01 - SUICIDE

Chair: S. Montgomery (U.K.), Z. Rihmer (Hungary)

- SO 0101 Suicide attempt and suicide risk in different depressive syndromes
Jules Angst (Switzerland)
- SO 0102 Prediction and prevention of suicide in mood disorders
Zoltan Rihmer (Hungary)
- SO 0103 Suicide risk in primary care
Julia Sinclair (United Kingdom)
- SO 0104 Do antidepressants raise suicide or agitation in adolescents?
Sitra Tauscher-Wisniewski (USA)

15.45 - 16.00

Coffee break

16.00 - 18.00

SO 02 - IMPROVING SIGNAL DETECTION IN PLACEBO-CONTROLLED STUDIES

Chair: I. Bitter (Hungary), H-J. Moeller (Germany)

- SO 0201 Successful studies require the right patients - using the MINI
to confirm diagnoses
David Sheehan (United States)
- SO 0202 Do effectiveness studies tell us the real truth?
Hans-Juergen Moller (Germany)
- SO 0203 Interpreting evidence in clinical Papers and Lectures
Kathleen Sheehan (United States)
- SO 0204 Increased severity of depression increases the chances of a difference
from placebo
Stuart Montgomery (United Kingdom)

18.00 - 19.00

Opening reception



SCIENTIFIC PROGRAMME

THURSDAY, December 6, 2007

08.30 - 10.30

SO 03 - TREATMENT RESISTANT DEPRESSION

Chair: Y. Lecrubier (France), D. Souery (Belgium)

- SO 0301 Residual symptoms and suicide risks in TRD
Yves Lecrubier (France)
- SO 0302 Where do we stand in the definition and treatment of TRD?
Daniel Souery (Belgium)
- SO 0303 Does switching classes help in treating TRD?
Pierre Oswald (Belgium)
- SO 0304 Patients with treatment resistant depression in my practice
Istvan Bitter (Hungary)

10.30 - 10.45

Coffee break

10.45 - 12.45

SO 04 - TREATMENT OF DEPRESSION AND ANXIETY IN THE "POST SSRI ERA"

Chair: S. Kasper (Austria)

- SO 0401 What are the future challenges in the treatment of Mood Disorders
Alan Wade (United Kingdom)
- SO 0402 Seasonal Affective Disorder - nature's influence on mood
Siegfried Kasper (Austria)
- SO 0403 Premenstrual Dysphoric Disorder - a condition worth to treat?
Elias Ericsson (Sweden)
- SO 0404 Are SSRI still "state of the art" or have we reached the "post SSRI era" in the treatment of major depressive disorder?
George Papakostas (United States)
Sponsored by an unrestricted educational grant of H. LUNDBECK A/S

12.45 - 13.45

Lunch

13.45 - 15.45

SO 05 - THE IMPORTANCE OF SLEEP IN DEPRESSION

Chair: D. Baldwin (U.K.), M. Isaac (U.K.)

- SO 0501 Importance of sleep disturbance in mood and anxiety disorders
David Baldwin (United Kingdom)
- SO 0502 Treating sleep with eszopiclone plus SSRIs in MDD or GAD
Stuart Montgomery (United Kingdom)



SO 0503 Effect of agomelatine on sleep in depression

Malcom Lader (United Kingdom)

SO 0504 Sleep deprivation - a forgotten tool?

Francesco Benedetti (Italy)

15.45 - 16.00

Coffee break

16.00 - 18.00

**SO 06 - EVERYDAY PROBLEMS IN TREATING DEPRESSION -
FOCUS ON SNRIs**

Chair: S. Kasper (Austria)

SO 0601 Recognising and effectively treating depression

Yves Lecrubier (France)

SO 0602 Treating depression with SNRIs - who will benefit most?

Mike Isaac (United Kingdom)

SO 0603 Initial effectiveness, partial and full remission in depression - focus
on long-term treatment

Serdar Dursun (United Kingdom)

SO 0604 Tolerability of SNRI antidepressants

Stuart Montgomery (United Kingdom)

Round table discussion

Sponsored by an unrestricted educational grant of PIERRE FABRE

18.00 - 20.00

SO 07 - OCD: DEFINING NEW BOUNDARIES

Chair: B. Bandelow (Germany), J. Zohar (Israel)

SO 0701 Should OCD still be classified as an anxiety disorder?

Naomi Fineberg (United Kingdom)

SO 0702 Is OCD a unitary disorder?

Dan Stein (South Africa)

SO 0703 OCD and schizophrenia: integral or overlapping

Joseph Zohar (Israel)

SO 0704 OCD and cognitive function

Sam Chamberlain (United Kingdom)



SCIENTIFIC PROGRAMME

FRIDAY, December 7, 2007

08.30 - 10.30 **SO 08 - PAIN: A NEGLECTED SYMPTOM OF AFFECTIVE DISORDER**
Chair: N. Fineberg (U.K.), D. Sheehan (USA)

- SO 0801 Prevalence of pain in depression
Borwin Bandelow (Germany)
- SO 0802 GAD, pain and pregabalin
Emanuela Mundo (Italy)
- SO 0803 Treatment of comorbid pain with venlafaxine or desvenlafaxine
Jean Michel Germain (France)
- SO 0804 Treatment of co-morbid pain with milnacipran or duloxetine
Mike Briley (France)

10.30 - 10.45 *Coffee break*

10.45 - 12.45 **SO 09 - DIAGNOSIS, TREATMENT AND RECEPTORS ARE CRITICAL
IN PATIENT RECOVERY IN MOOD AND ANXIETY DISORDERS**
Chair: H-J. Moeller (Germany)

- SO 0901 Misdiagnosis in mood disorders
David Sheehan (United States)
- SO 0902 Room for improvement in the treatment of generalised anxiety disorder
David Baldwin (United Kingdom)
- SO 0903 Treatments and their mechanisms of action in major depressive disorder
Stuart Montgomery (United Kingdom)

Sponsored by an unrestricted educational grant of ASTRAZENECA

12.45 - 13.45 *Lunch*

13.45 - 15.45 **SO 010 - TREATMENT OF THE ELDERLY**
Chair: P. Baumann (Switzerland), S. Montgomery (U.K.)

- SO 1001 Treatment of insomnia in the elderly
Judy Caron (United States)
- SO 1002 Efficacy and safety of pregabalin for the treatment of GAD in elderly patients
Kevin Murphy (United States)
- SO 1003 Treatment of schizophrenia in the elderly
Marielle Eerdeken (Belgium)
- SO 1004 Pharmacokinetic influences on treatment of the elderly
Pierre Bauman (Switzerland)

15.45 - 16.00 *End of meeting*



P01. Impulsivity in bipolar patients with and without substance use. **A. Afkhamibrahimi**^{1,2}, **B. Daneshamouz**^{1,2,3}, **M. Shekarian**¹ (¹Iran University of Medical Sciences; ²Mental Health Research Center, Tehran Institute of Psychiatry; ³Iran Psychiatry Centre, Iran).

P02. Quetiapine and classical mood stabilizers in the long-term treatment of bipolar disorder: a 4-year follow-up naturalistic study. **A.C. Altamura**¹, **E. Mundo**¹, **B. Dell'Osso**¹, **G. Taccini**¹, **M. Buoli M**¹, **M. Serati**¹, **J.R. Calabrese**² (¹Dept. of Psychiatry, University of Milan; IRCCS Fondazione Ospedale Maggiore Policlinico Mangiagalli, Milan, Italy; ²Mood Disorders Program, Department of Psychiatry, Case Western Reserve University, University Hospitals of Cleveland, Cleveland, Ohio, USA).

P03. Adokot study: safety of sodium divalproate (Dépakote-R) in adolescents suffering from bipolar disorder in manic, mixed or hypomanic phase. **J. Azorin**, **D. Cohen**, **H. Caci**, **R. Garay**, **A. Hameg** (¹Hospital Sainte-Marguerite, Marseille; ²School of Medicine, Hospital La Pitié-Salpêtrière, Paris; ³Hospital Archet II Nice, ⁴EA2381, University Paris 7, Paris, ⁵Sanofi-Aventis France, Paris, France).

P 04. Survival rates of maintenance treatment with Venlafaxine ER in patients with somatic symptoms. **W. Bahk**, **H. Seo**, **Y. S. Woo**, **T. Jun**, **J. Chae** (Department of Psychiatry, College of Medicine, the Catholic University of Korea, Seoul, South Korea).

P 05. Relationship between predominant episode and clinical features in Bipolar I Disorder. **W. Bahk**, **H. Seo**, **Y. S. Woo**, **T. Jun**, **J. Chae** (Department of Psychiatry, College of Medicine, the Catholic University of Korea, Seoul, South Korea).

P 06. Resolution of sexual dysfunction during acute treatment of major depression with Milnacipran. **D. Baldwin**¹, **R. Moreno**², **M. Briley**³ (¹Clinical Neuroscience Division, School

of Medicine, University of Southampton, Southampton, UK; ²Mood Disorders Unit-Department of Psychiatry, University of São Paulo Medical School, Sao Paulo, Brazil; ³Neurobiz, Castres, France).

P07. Results from a phase III study of once-daily extended release quetiapine fumarate (quetiapine XR) monotherapy in patients with generalised anxiety disorder. **B. Bandelow**¹, **J. Bobes**², **A. Ahokas**³, **I. Eggens**⁴, **S. Liu**⁵, **M. Brecher**⁵ (¹Department of Psychiatry and Psychotherapy, University of Goettingen, Goettingen, Germany, ²Department of Psychiatry, University of Oviedo, Asturias, Spain, ³Mehilainen Clinic, Helsinki, Finland, ⁴AstraZeneca R&D, Södertälje, Sweden, ⁵AstraZeneca Pharmaceuticals, Wilmington, USA).

P08. Duloxetine in depressed alcoholic patients. **E. Batlle**¹, **T. Fernández**¹, **V. Gironès**², **J. Martínez**², **I. Rivas**³, **C. Romero**³ (¹Hospital Mataró, Psychiatry Service, Mataró, ²Hospital Calella, Drug Dependence Service, Calella, ³Centre Delta, Badalona, Spain).

P09. Results from a phase III study of extended release quetiapine fumarate (quetiapine XR) as add-on to antidepressants in patients with major depressive disorder (MDD). **M. Bauer**¹, **H. Pretorius**², **W. Earley**³, **P. Lindgren**⁴, **M. Brecher**³ (¹Department of Psychiatry and Psychotherapy, University Hospital Carl Gustav Carus, Dresden, Germany, ²Department of Psychiatry, University of Pretoria & Weskoppies, Hospital Pretoria, South Africa, ³AstraZeneca Pharmaceuticals, Wilmington, USA, ⁴AstraZeneca R&D, Södertälje, Sweden).

P10. Clock gene polymorphism RE1801260 biases response to light treatment after sleep deprivation. **L. Lietti**, **F. Benedetti**, **B. Barbini**, **C. Lorenzi**, **E. Marino**, **M. Cigala Fulgosi**, **A. Pontiggia**, **S. Dallaspesza**, **C. Colombo**, **E. Smeraldi** (Scientific Institute and University Vita-Salute San Raffaele, Department of Neuropsychiatric Sciences, Milan, Italy).



P11. Homeostatic and allostatic response to sleep deprivation in bipolar depression. **M. Cigala Fulgosi, F. Benedetti, C. Gavinelli, B. Barbini, C. Colombo, E. Smeraldi** (Scientific Institute and University Vita-Salute San Raffaele, Department of Neuropsychiatric Sciences San Raffaele Turro, Milan, Italy).

P12. Stressful life events bias neural correlates of emotional processing in bipolar disorder. **F. Benedetti, D. Radaelli, A. Bernasconi, S. Dallaspezia, V. Unterhofer, C. Colombo, A. Falini, G. Scotti, E. Smeraldi** (Scientific Institute and University Vita-Salute San Raffaele, San Raffaele Turro, Milan, Italy).

P13. A VNTR Polymorphism in hPER3 Gene Influences clinical characteristics of bipolar disorder. **S. Dallaspezia, F. Benedetti, C. Lorenzi, A. Pirovano, C. Colombo, E. Smeraldi** (Scientific Institute and University Vita-Salute San Raffaele, Department of Neuropsychiatric Sciences, San Raffaele Turro, Milan, Italy).

P14. Bipolar disorder and schizophrenia influence neural responses in amygdala and anterior cingulate to emotional faces. **S. Poletti, F. Benedetti, D. Radaelli, S. Dallaspezia, A. Bernasconi, C. Colombo, R. Cavallaro, A. Falini, G. Scotti, E. Smeraldi** (Scientific Institute and University Vita-Salute San Raffaele, San Raffaele Turro, Milan, Italy).

P15. The effect of repetitive Transcranial Magnetic Stimulation. **J. Chae¹, S. Lee², K. Baek³, J. Jeong³** (¹The Catholic University of Korea, Seoul, ²Inje University, Koyang, ³Korea Advanced Institute of Science and Technology, Daejeon, South Korea).

P16. Stress and alcohol **G. Danevski, P. Dimitrijevska** (Psychiatric Hospital Skopje, Skopje, Macedonia).

P17. Consultation-liaison psychiatry: managing suicide attempters. **J. Del Río Vega, R. Fernandez Garcia-Andrade** (Hospital

Clínico Universitario San Carlos. Madrid, Spain).

P18. Social and occupational functioning in patients with partial or complete remission of a major depressive disorder episode. **H. Delgado-Cohen¹, I. Romera¹, V. Perez², J. M. Menchón³, P. Polavieja¹, B. Yruretagoyena¹, I. Gilaberte¹** (¹Clinical Research Department, Lilly, Spain, ²Department of Psychiatry, Hospital de Sant Pau i de la Santa Creu, Barcelona, REM-TAP, ³Department of Psychiatry, Hospital de Bellvitge, Barcelona, REM-TAP, Spain).

P19. Optimal cutoff point to define remission by the Hamilton rating scale for depression according to normal social and occupational functioning. **H. Delgado-Cohen¹, I. Romera¹, V. Perez², J. M. Menchón³, P. Polavieja¹, B. Yruretagoyena¹, I. Gilaberte¹** (¹Clinical Research Department, Lilly, Spain, ²Department of Psychiatry, Hospital de Sant Pau i de la Santa Creu, Barcelona, REM-TAP, ³Department of Psychiatry, Hospital de Bellvitge, Barcelona, REM-TAP, Spain).

P20. Escitalopram in the treatment of Premenstrual Dysphoric Disorder (PMDD). **E. Eriksson¹, A. Ekman¹, S. Sonclair², K. Sörvik³, C. Ysander⁴, U. B. Mattson⁴, H. Nissbrandt¹** (¹Department of Pharmacology, University of Göteborg, ²Läkarhuset, ³Kungälv Hospital, University of Göteborg, ⁴Institute of Clinical Neuroscience, University of Göteborg, Göteborg, Sweden).

P21. Efficacy and tolerability of Escitalopram in patients with mild, moderate and severe depression. **S. Stamouli¹, A. Yfantis², A. Zouganeli³, E. Lampousis⁴, D. Giailoglou⁵, I. Parashos⁵** (¹Psychiatric Clinic, Eginition University Hospital, Athens, ²Center for Mental Health, General Hospital, Kalamata, ³Psychiatric Clinic, Agia Barbara General Hospital, Athens, ⁴Psychiatric Clinic, Naval and Veterans Hospital, Athens, ⁵Lundbeck Hellas SA, Athens, Greece).



P22. Effects of Escitalopram on disability caused by depression. **Yfantis¹, S. Stamouli², M. Tzanakaki³, V. Lagari⁴, D. Giailoglou⁵, I. Parashos⁵** (¹Center for Mental Health, General Hospital, Kalamata, ²Psychiatric Clinic, Eginition University Hospital, Athens, ³Psychiatric Clinic, General Hospital, Chania, ⁴Psychiatric Hospital, Tripolis, ⁵Lundbeck Hellas SA, Athens, Greece).

P23. Unique mechanism of action of quetiapine in bipolar depression. **J. Goldstein¹, G. Christoph¹, M. Brecher¹, R. McIntyre²** (¹AstraZeneca Pharmaceuticals LP Wilmington USA, ²Mood Disorders Psychopharmacology Unit, University of Toronto Toronto, Canada).

P24. PET-measured D2, 5HT2A, and NET occupancy by quetiapine and n-desalkyl-quetiapine (norquetiapine) in non-human primates. **J. Goldstein¹, S. Nyberg², A. Takano³, S. Grimm¹, B. Gulyas³, D. McCarthy¹, C. Lee¹, C. Halldin³, L. Farde^{2,3}** (¹AstraZeneca Pharmaceuticals LP, Wilmington, USA, ²AstraZeneca Pharmaceuticals, Södertälje, Sweden, ³Department of Clinical Neuroscience, Karolinska Institutet, Stockholm, Sweden).

P25. Natural killer cell in patients with major depressive disorder. **S. Han, Y.W. Jeon, E.J. Park** (Department of Psychiatry, Our Lady of Mercy Hospital, the Catholic Universe of Korea, the Catholic University of Korea, Incheon, South Korea).

P26. Recent 5-year trends of prescription patterns in inpatients with bipolar disorder in Korea. **D. Jon¹, E. Kim², H. S. Cho², E. Lee³, S. Kim², J. H. Seok¹, T. S. Kim²** (¹Hallym University Sacred Heart Hospital Anyang, ²Yonsei University College of Medicine, Seoul, ³National Health Insurance Corporation Ilsan Hospital, Koyang, South Korea).

P27. Psychopathology in the offspring of mothers with risk of bipolar disorder in community sample. **D. Jon, H. Hong, J. Seok,**

N. Hong, Y. So (¹Hallym University Sacred Heart Hospital Anyang, South Korea).

P28. Epidemiology of major depressive disorder in Korea. **H. Jung¹, J-Y Lee¹, S. Kim², M. Cho¹** (¹Department of Psychiatry, Seoul National University College of Medicine, ²Department of Psychiatry, Korea University, College of Medicine, Seoul, South Korea).

P29. Influence social factors on level of anxiety. **T. Kadyrova, N. Myrzamatova** (Kyrgyz State Medical Academy, Republic Centre Of Mental Health, Bishkek, Kyrgyzstan).

P30. Different pattern of surface shape deformity of thalamus between obsessive-compulsive disorder and schizophrenia. **D. Kang¹, S. Kim², C. Kim¹, J. Choi¹, J. Jang¹, M. Jung¹, J. Lee², J. Kwon¹** (¹Department of Psychiatry, Seoul National University College of Medicine, Seoul, ²Department of Biomedical Engineering, Hanyang University, Seoul, South Korea).

P31. The use of quetiapine as an adjunct in the pharmacotherapy of generalised anxiety disorder: a flexible dose, open-label trial. **M. Katzman^{1,2,3}, M. Vermani¹, L. Jacobs¹, M. Marcus¹, B. Kong B¹, S. Lessard⁴, W. Galarraga⁵, L. Struzik¹, C. Iorio¹, A. Gendron⁶** (¹START Clinic for Mood and Anxiety Disorders, ²University of Toronto, ³Northern Ontario School of Medicine, ⁴University of Ottawa, Mont Fort Hospital, ⁵Behavioural Science Program McMaster University, ⁶Astrazeneca Canada inc., Mississauga, Ontario, Canada).

P32. Quality of Web based information on social phobia. **Y. Khazaal, A. Chatton, S. Cochand, D. Knobel, D. Zullino** (Division of substance abuse, Geneva University Hospitals, Geneva, Switzerland).

P33. Impact of depression on work productivity in employees who visit psychiatric clinic. **W. Kim, J. M. Woo** (Seoul Paik Hospital, Inje University, Seoul, South Korea).



P34. Association study of A2a Adenosine receptor gene polymorphism. **W. Kim, J. M. Woo** (Seoul Paik Hospital, Inje University, Seoul, South Korea).

P35. Association between serotonin-related gene polymorphisms and panic disorder. **Y. Kim¹, H. K. Yoon¹, J. C. Yang², H. J. Lee¹** (¹Departement of Psychiatry, Korea University, College of Medicine, Seoul, ²Departement of Psychiatry, Chunbuk National University, Chunju, South Korea).

P36. Temperament and character in subjects with obsessive-compulsive disorder. **S. Kim, C. Kim** (Department of Psychiatry and Institute of Behavioral Science in Medicine, Yonsei University, Seoul, South Korea).

P37. Gender dimorphic association between obsessive-compulsive disorder and 5-HT1DB, DRD4, and MAOA gene. **C. Kim, S. Kim** (Department of Psychiatry and Institute of Behavioural Science in Medicine, Seoul, South Korea).

P38. Life Quality of Depressed, Somatically Ill and Average Child Populations. **Enikő Kiss, Dóra Skultéti, Ágnes Vetró** (Child Psychiatry Unit, University of Szeged, Hungary).

P39. Poly- and Multipsychopharmacy in psychiatric inpatient populations of three European countries: Data from AMSP (Arzneimittelsicherheit in der Psychiatrie), a European pharmacovigilance system. **A. Konstantinidis¹, U. Moser¹, G. Pail¹, R. Grohmann², A. Horvath³, R. Engel², S. Kasper¹** (¹Division of Biological Psychiatry, Medical University of Vienna, Austria, ²Department of Psychiatry, Ludwig Maximilians University, Munich, Germany, ³Psychiatric Private Clinic Sanatorium Kilchberg/Zürich, Switzerland).

P40. Mapping white matter alterations in obsessive-compulsive disorder. **J. Kwon¹, D. H. Kang¹, B. M. Gu², W. H. Jung², J. Y. Park², J. S. Choi¹, M. H. Jung¹** (¹Department of Psychiatry,

Seoul National University College of Medicine, ²Interdisciplinary Program in Brain Science & Cognitive Science, Seoul, South Korea).

P41. Does a diagnosis of depression or the prescription of an antidepressant influence hypnotic use in primary care? **M. Lader¹, J. Donoghue²** (¹Institute of Psychiatry, Kings College, London, ²School of Pharmacy & Chemistry, John Moores University, Liverpool, United Kingdom).

P42. Therapeutics effects of pregabalin in anxiety disorders. **A. Lera** (Operative Unit Psychiatry, Giulianova, Italy).

P43. Perfect NERIT (Neuromuscular Emotional Relaxing Treatment Integrated): a new therapeutic method in anxiety disorders. **A. Lera** (Operative Unit Psychiatry, Giulianova, Italy).

P44. Comparison of time to rehospitalization among patients with schizophrenic disorder, bipolar disorder, or major depressive disorder. **C. Lin, Y.-S. Chen, M.-C. Chen, L.-S. Chou, K.-S. Lin, C.-Y. Lin** (Kai Suan Psychiatric Hospital, Kaohsiung, Taiwan).

P45. Genetic bases of comorbidity between mood disorders and migraine: possible role of Serotonin Transporter Gene. **C. Lorenzi, F. Buongiorno, E. Marino, A. Pirovano, L. Franchini, E. Smeraldi** (Ospedale San Raffaele, Università Vita-Salute, Milan, Italy).

P46. The evaluation of the efficacy of psychokinetherapeutical techniques in depressive vascular disorder associated with peripheral paresis of the facial nerve. **D. Marinescu¹, I. Marinescu², M. Pirlog¹** (¹University of Medicine and Pharmacy of Craiova, ²Clinic of Psychiatry, Craiova, Romania).

P47. The evaluation of the vascular risk factors for Alzheimer disease in prodromal depressive syndrome associates with MCI. **D. Marinescu,**



L. Mogoanta, T. Udristoiu (University of Medicine and Pharmacy of Craiova, Craiova, Romania).

P48. Role of serotonergic gene polymorphisms on response to Transcranial Magnetic Stimulation in depression. **E. Marino, D. Rossigni, A. Malaguti, C. Lorenzi, A. Pirovano, L. Poliedri, R. Zanardi, A. Lucca, E. Smeraldi** (Ospedale San Raffaele, Università Vita-Salute, Milan, Italy).

P49. Topiramate efficacy and tolerability at adolescents with posttraumatic disorder (PTSD) which have comorbid panic disorder (PD) or depression. **I. Martsenkovsky, Y. Bikshaeva, Martsenkovska** (Ukrainian Research Institute of Social and Forensic Psychiatry and Drug Abuse, Kyiv, Ukraine).

P50. Impact of culture on male and female patients coping with pain. **Mahrukh Masood, K. S. Malik, Mahnoor Masood** (Shalamar Hospital, Lahore, Pakistan).

P51. A randomised, placebo-controlled study of once-daily extended release quetiapine fumarate (quetiapine XR) monotherapy in patients with major depressive disorder (MDD). **S. Montgomery¹, A. Cutler², A. Lazarus³, M. Schollin⁴, M. Brecher³** (¹Imperial College School of Medicine, University of London, London, United Kingdom, ²Department of Psychiatry, University of Florida, Florida, USA, ³AstraZeneca Pharmaceuticals Wilmington, USA, ⁴AstraZeneca R&D, Södertälje, Sweden).

P52. Search for medical treatment and comorbidity of chronic medical disorders and somatoform disorder with bipolar spectrum subgroups in a population-based sample of Sao Paul. **D. Moreno¹, L. Andrade²** (¹Mood Disorders Unit, School of Medicine, ²Psychiatric Epidemiology Unit, School of Medicine, University of Sao Paulo, Sao Paulo, Brazil).

P53. Synergistic physico psychotherapy (SPPT) 10 year approach for neuropsychiatric patients

(with depression or pain). **W. N. Morokutti** (Für Neurologie, Psychiatrie, Psychotherapeut, International membership in the American psychiatric association, Wien, Austria)

P54. Efficacy of Pregabalin and Venlafaxine-XR in Generalized Anxiety Disorder: Results of a Double-Blind, Placebo-Controlled 8-Week Trial (A0081012). **T. K. Murphy, G. Nivoli, A. Petralia, F. Mandel, T. Leon** (Pfizer Global Pharmaceuticals, Pfizer Inc, New York, NY, USA).

P55. Regulating negative moods through affect, behavior, cognitive, and social strategies. **J. Overholser, A. Marquart, N. Peak** (Case Western Reserve University, Cleveland, USA).

P56. Symptom based cluster typology of obsessive-compulsive disorder. **K. Paik, K. Lee, H. Kim** (Department of Psychiatry, Dankook University, Cheon-An, South Korea).

P57. An assessment of Drug-Drug interaction: the effect of desvenlafaxine succinate and Duloxetine on the pharmacokinetics of desipramine in healthy subjects. **A. Patroneva¹, S. Connolly², P. Fatato¹, A. Nichols¹, J. Paul¹, C. Guico-Pabia¹** (¹Wyeth Research Collegeville, PA USA, ²CentraState Medical Center Freehold, NJ USA).

P58. Searching Susceptibility Loci for mania: a Sib pairs pilot study. **A. Pirovano, C. Lorenzi, D. Dotoli, F. Buongiorno, E. Marino, M. Catalano, E. Smeraldi** (Ospedale San Raffaele, Università Vita-Salute, Milan, Italy).

P59. Desvenlafaxine succinate versus Placebo for prevention of depressive relapse in adult outpatients with major depressive disorder. **B. Pitrosky¹, K. Rickels², S. Montgomery³, K. Tourian⁴, J. Guelfi⁵, S. Padmanabhan⁴, J. Germain¹, C. Leurent¹, C. Brisard¹** (¹Wyeth Research Paris, France, ²University of Pennsylvania, Philadelphia, PA, USA, ³Imperial College School of Medicine London, United



POSTERS

Kingdom, ⁴Wyeth Research Collegeville, PA, USA, ⁵CCME, Centr. Sainte-Anne, Univ. Paris V, Paris, France).

P60. Social functioning in seasonal affective disorder before and after treatment with duloxetine. **E. Pjrek, M. Willeit, N. Praschak-Rieder, A. Konstantinidis, S. Kasper, D. Winkler** (Department of Psychiatry and Psychotherapy, Medical University of Vienna, Austria).

P61. Mood symptoms and disorders in association with dietary intake. **R. Rintamäki, T. Partonen, J. Haukka, J. Virtamo, D. Albanes, J. Lönnqvist** (National Public Health Institute, Helsinki, Finland)

P62. Subthalamic nucleus deep brain stimulation impact on mood disorders in patients with Parkinson's disease. **I. Chereau-Boudet¹, J. Rougier¹, I. De Chazeron¹, P. Deros², M. Ulla², J. Lemaire³, F. Durif², P. Llorca¹** (¹Psychiatry Department CHU Clermont-Ferrand, ²Neurology Department CHU Clermont-Ferrand, ³Neurosurgery Department CHU Clermont-Ferrand, Clermont-Ferrand, France).

P63. Adverse effect from the combined treatment of a manic patient with pharmacotherapy and rTMS. **P. Sakkas, C. Theleritis, C. Psarros, T. Paparrigopoulos, G. Papadimitriou** (Athens University Medical School, 1st Dept. of Psychiatry, Eginition Hospital, Athens, Greece).

P64. The PCMAD (Primary Care Mood & Anxiety Diagnoser): the development of a diagnostic tool to Detect SAD, GAD, panic disorder, bipolar disorder and depression. **M. Vermani¹, J. Westermeyer¹, M. Stone¹, M. Marcus², M. A. Katzman³** (¹Adler School of Professional Psychology, Chicago, USA, ²York University, Toronto, Canada, ³University of

Toronto & Northern Ontario School of Medicine, Toronto, Canada).

P65. Escitalopram and duloxetine in the treatment of major depression. **R. W. Lam¹, H. F. Andersen², A. G. Wade³** (¹University of British Columbia Vancouver, BC, Canada, ²H. Lundbeck A/S, Copenhagen, Denmark, ³CPS Clinical Research Centre, Glasgow, United Kingdom).

P66. A comparative study of the efficacy of acute and continuation treatment with escitalopram versus duloxetine in patients with major depressive disorder. **A. Wade¹, K. Gembert², I. Florea²** (¹CPS Clinical Research Centre, Glasgow, United Kingdom, ²H. Lundbeck A/S, Copenhagen, Denmark).

P67. The efficacy and tolerability of duloxetine in fall-winter depression. **D. Winkler, E. Pjrek, N. Praschak-Rieder, M. Willeit, A. Konstantinidis, S. Kasper** (Department of Psychiatry and Psychotherapy, Medical University of Vienna, Austria).

P68. Changes on subjective estimates of sleep after 6 weeks treatment with olanzapine in acute mania. **B. Yoon¹, W. Bahk², D. Jon³, S. Lee⁴, J. Lee⁵, S. Won⁶, J. Seo⁷, K. Min⁸** (¹Department of Psychiatry, Naju National Hospital, Naju, ²Department of Psychiatry, College of Medicine, The Catholic University of Korea, Seoul, ³Department of Psychiatry, College of Medicine, Hallym University Anyang, ⁴Department of Psychiatry, College of Medicine, Won-Kwang University, Iksan, ⁵Department of Psychiatry, Dongsuh Hospital, Masan, ⁶Department of Psychiatry, College of Medicine, Daegu Catholic University, Daegu, ⁷Department of Psychiatry, College of Medicine, Konkuk University, Choongju, ⁸Department of Psychiatry, College of Medicine, Chung-Ang University, Seoul, South Korea).



Audio-Visual Facilities:

Equipment for computerised Power Point presentations is provided during the scientific sessions. Floppy disks and CD-Rom for Power Point presentations can be tested prior to presentation in the slide preview room.

Floppy disks or CD-Rom must be handed over to the Slide preview room technicians at least forty minutes before the beginning of the sessions and must be collected directly by the speakers at the end of the session.

It is essential for the smooth running of the sessions that all speakers hand in their Power Point presentation in due time.

European Accreditation:

10 European UEMS (European Union of Medical Specialists) credits have been recognized for this programme.

Certificate of Attendance:

A certificate of attendance is provided on request at the registration desk on the last day of the Congress.





GENERAL INFORMATION

The “**7th International Forum on Mood and Anxiety Disorders**” is held at the Hotel Hilton, Hess András tér 1-3, Budapest from 5-7 December, 2007.

Admission (Badges):

The participant's name badge is provided at the registration desk. All participants are requested to wear the badge throughout the Congress. Only badge holders are admitted to the appropriate sessions, exhibition and social events.

Coffee breaks and Lunches:

During the Congress session breaks, coffee breaks and lunches are served free of charge to all registered participants, wearing Congress badges.

City

The capital city of Hungary, Budapest, was created out of the unification of the separate historic towns of Buda, Pest and Óbuda in 1873. The city, bisected by the River Danube, covers an area of two hundred square miles and it is divided into 23 administrative districts, and home today to a population of 1.8 million people.

Electricity:

Voltage in Hungary is 220 volts, and plugs are of the two-pin continental type.

Exchange:

All visitors are advised to exchange currency only at accredited places. The majority of banks have 24-hour ATM's some of which can also exchange foreign currency. Individual banks and travel agencies are free to set their own rates (based on those advertised by the Hungarian National Bank) but they must be clearly displayed. The Hungarian currency is the forint. There are coins to the value of 1, 2, 5, 10, 20, 50 and 100 forints, and notes for 200, 500, 1,000, 2,000, 5,000, 10,000 and 20,000 forints.

All the most popular credit, debit and charge cards can be used in banks and in ATM's to withdraw forints, and in hotels, restaurants and shops for purchases.

Insurance:

The Congress organizers cannot accept liability for personal injuries sustained, or for loss or damage to property belonging to Congress participants and accompanying persons, either during or as a result of the Congress. Registration does not include insurance.

Language:

The official language of the Congress is English. No simultaneous translation is provided.

Secretariat Desk:

The secretariat desk is open on Wednesday, December 5th, 2007 and stays open all through the Congress as follows:

- Wednesday, December 5 11h00 - 18h00
- Thursday, December 6 08h00 - 20h00
- Friday, December 07 08h00 - 16h00

Smoking Policy:

The 7th International Forum on Mood and Anxiety Disorders wishes to be a non-smoking congress.

Useful Telephone Numbers:

24-hour medical assistance: Falck SOS Hungary. Tel: **200-0100**

24-hour dental assistance: Tel: **267-9602**

Budapest's pharmacies (gyógyszertár in Hungarian) are well stocked and can provide medicaments for most common ailments. The location of the nearest all-night chemist is displayed on the door of every pharmacy.

Other Useful Numbers:

- | | |
|-----------------------|-------------------------|
| • Airport | (+36) 1 296 9696 |
| • luggage service T2A | (+36) 1 296 8108 |
| • luggage service T2B | (+36) 1 295 3480 |
| • Taxis Taxi | 555-5555 |

ANNOUNCEMENT OF NEXT FORUM



**The 8th International Forum
on Mood and Anxiety Disorders
will be held on 12-14 November, 2008
in Vienna, Austria**

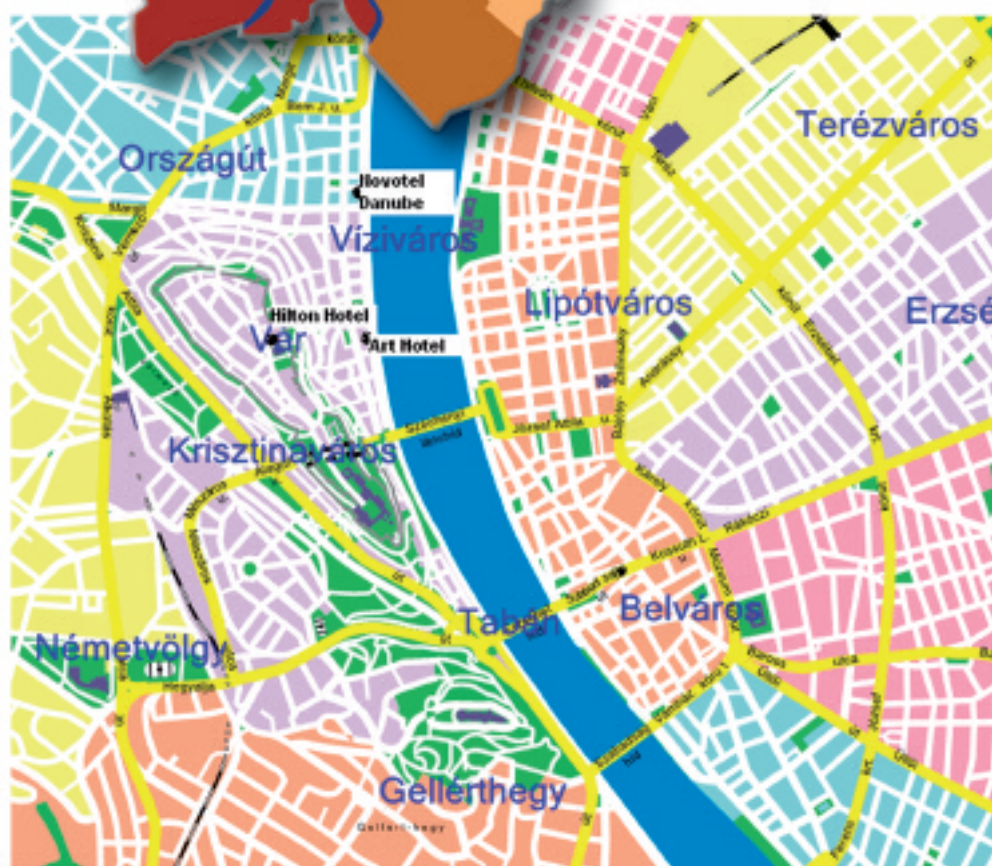



Why drift through life
when you can dance?

Superior efficacy • Fast • Excellent tolerability

Lundbeck



Cipralex
escitalopram

Cipralex. Abbreviated Prescribing Information. Presentation: "Cipralex", tablets containing 5, 10 and 20 mg escitalopram (as citalate). Indications: Major depression, Generalised anxiety disorder, Panic disorder with or without agoraphobia, Social anxiety disorder, Obsessive compulsive disorder. Dosage: Usual dose 10 mg once daily. Maximum dose 20 mg/day. In the elderly (>65 years), in panic disorder patients and in patients with reduced hepatic function an initial dose of 5 mg/day is recommended. Caution in patients with severely reduced renal function. Not recommended in children

and adolescents (<18 years). When stopping treatment with escitalopram, the dose should be gradually reduced over a period of one or two weeks. Contraindications: Hypersensitivity to escitalopram. Concomitant treatment with non-selective MAOis. Pregnancy and lactation: Careful consideration prior to use in pregnant women. Breast-feeding women should not be treated. Precautions: The special warnings and precautions which apply to the class of SSRIs. Drug interactions: Reversible, selective MAOis, Selegiline (irreversible MAO-B inhibitor). Medicinal products lowering the

seizure threshold. St. John's Wort. Enzyme inhibitors (e.g. omeprazole and cimetidine) may require reduction of escitalopram dose. Drugs metabolised by enzymes CYP 2D6 or 2C19. Adverse events: Most frequent during first or second weeks, comprise the SSRI class adverse events, e.g. nausea, diarrhoea, and constipation. Overdose: Doses between 400 and 800 mg of escitalopram alone have been taken without any severe symptoms. Consult full prescribing information before prescribing. K. Lundbeck A/S, Copenhagen, Denmark. Date of preparation: January 2007